

5161

NIPPLO RIDOTTO

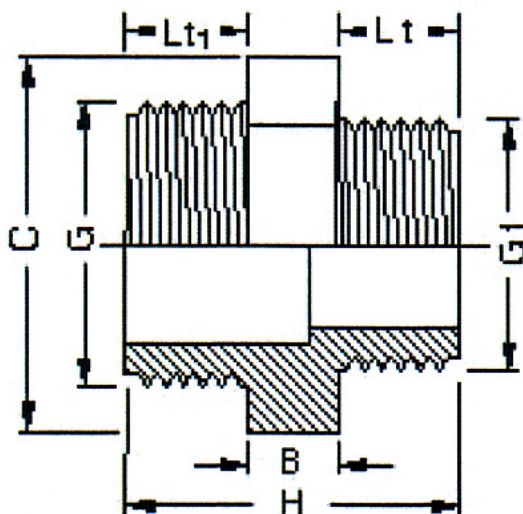
**PVC A PRESSIONE –
RACCORDI**
Raccordi filettati

TABELLA DIMENSIONI

GXG1	Lt	Lt1	C	B	H	Peso gr.	PFA(PN)
1/2"X3/8"	16	11	24	12	41	11	16
3/4" X3/8"	17	16	30	12	46	18	16
3/4"X1/2"	17	11	30	12	42	17	16
1"X1/2"	19	17	38	12	49	27	16
1"X3/4"	19	16	36	12	48	26	16
1 1/4"X3/4"	22	19	50	16	57	57	16
1 1/4"X1"	22	17	50	16	55	54	16
1 1/2"X1"	22	22	50	16	60	63	16
1 1/2"X1 1/4"	22	22	50	16	57	60	16
2"X1 1/4"	26	22	65	16	63	104	16
2"X1 1/2"	26	22	65	16	64	97	16
2 1/2"X1 1/2"	30	22	80	20	76	170	16
2 1/2"X2"	30	22	80	20	72	176	16
3"X2"	33	30	90	20	83	265	16
3"X2 1/2"	33	26	90	20	79	251	16
4"X2 1/2"	41	33	120	20	94	435	16
4"X3"	41	30	120	20	91	422	16

NOTE:

Filettatura interna cilindrica UNI EN 10226 – a tenuta sul filetto