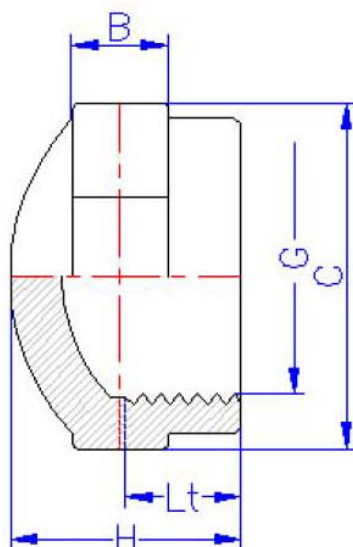

5071

CALOTTA

**PVC A PRESSIONE-
RACCORDI**
 Raccordi filettati

TABELLA DIMENSIONI

G	Lt	C	B	H	Peso gr.	PFA(PN)
3/8"	13	22	12	25	9	16
1/2"	17	24	12	29	17	16
3/4"	18	30	12	31	24	16
1"	20	36	12	37	33	16
1 1/4"	22	46	16	40	53	16
1 1/2"	22	50	16	40	87	16
2"	26	74	12	45	119	16
2 1/2"	30	80	20	51	205	16
3"	33	95	20	55	375	16
4"	40	120	20	63	425	16

NOTE:

Filettatura interna cilindrica UNI EN 10226 – a tenuta sul filetto